

Vertiv™ Liebert® GXT5 UPS

8 to 10KVA, MV

208V IN (L1, L2, N, G), 208V OUT

Quick Installation Guide



Thank you for your recent purchase of a Vertiv UPS! We appreciate your business and are confident that your new product will provide many years of uninterruptible power to your connected equipment. With this purchase, you may also want to consider Vertiv's complete line of racks, PDUs, thermal solutions, KVM switches, and serial consoles. Vertiv also offers a broad array of services and extended warranties. If you require any assistance or support please don't hesitate to reach out to one of our resellers, local rep firms, or directly to us at 1-800-222-5877 menu option 3, or email at warranty@vertiv.com. We stand ready to support you. We sincerely hope that you'll continue to select Vertiv for all of your future infrastructure needs!

The Vertiv Team

IMPORTANT: Before installing, connecting to supply or operating your Vertiv™ Liebert® GXT5 UPS, please review the Safety and Regulatory Statements sheet. For detailed installation, operating, maintenance and troubleshooting information refer to the Liebert GXT5 User Guide for your model available at www.Vertiv.com.

Installation

1. Inspecting the UPS

Inspect the UPS for any signs of obvious damage. If damage is visible, do not proceed. Call our warranty support line for assistance at 1-800-222-5877 menu option 3, or email at microups.warranty@vertiv.com.

2. Choosing a location

Install the UPS in a temperature-controlled environment that is free of corrosive and conductive contaminants. Avoid locations near heat or water sources and exposed to direct sunlight.

For proper ventilation, leave four inches clearance on all sides of the UPS.

The input outlet should be nearby and easily accessible.

Rear of GXT5 UPS 8000/10KMVRT6UXLN Shown

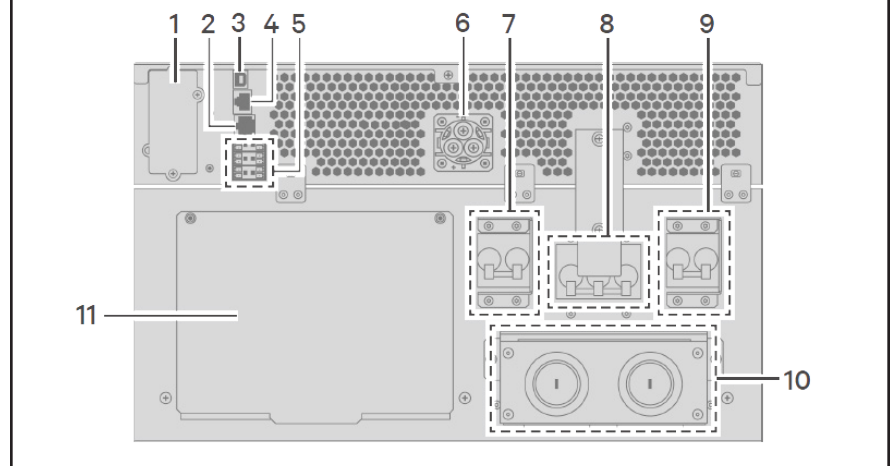

#	Description
1	Liebert® IntelliSlot Port
2	RS-232 port - Used for CLI
3	USB port
4	RS-485 port - Used for external temperature sensors
5	Dry-contacts, Battery Detection (3), REPO input (REPO)
6	External-battery-cabinet connector
7	Output breaker
8	Maintenance breaker
9	Input breaker
10	Knockouts for hard-wired input and output
11	Cover for power-distribution box connector

NOTE: The UPS has a gravity-sensor function that automatically rotates the LCD display depending on rack or tower installation.

3. Installing the UPS

The UPS and optional External Battery Cabinets may be installed in either a tower or rack configuration.

- For tower installation, assemble and attach the tower support stands and spacers.
- For rack installation:
 1. Remove internal batteries from the UPS so it can be relocated into the rack more easily, attach the handles to the UPS.
 2. Install the rail kit in the rack.
 3. Install the UPS in the rack.

NOTE: Align shelf of rack kit with rack U number for proper alignment.

4. Secure the handles to the rack.

After UPS installation, reinstall internal batteries.

Connections

4. Connecting External Battery Cabinet (Optional)

External battery cabinets (EBC) provide longer battery run-time for connected devices. Refer to Liebert® GXT5 User Guide, to select the appropriate model and quantity for your Liebert GXT5 model and applications.

- Verify that the EBC breaker is in the “Off” position.
- Connect one end of the supplied EBC cable to the UPS and one end to the battery cabinet. If connecting more than one external battery, connect one end of the external battery cable to the second connector on the battery cabinet, then connect the other end to the next battery cabinet.

GXT5 UPS to External Battery Cabinet Connections

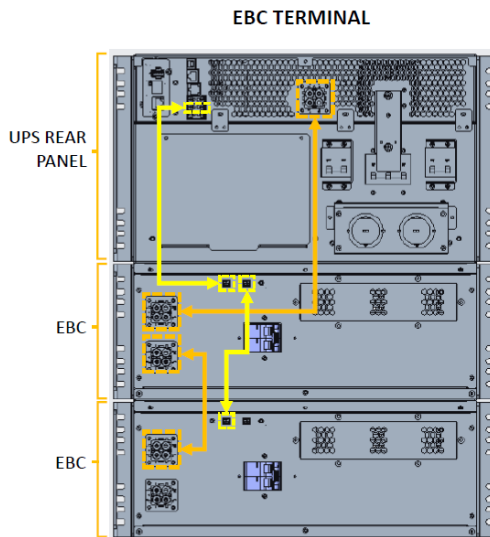

WIRING	Recommended external breaker
Recommended external breaker	60 A
Recommended wire (all wires)	6 AWG (10 mm ²) 75 °C copper wire
Maximum wire accepted by terminal block	4 AWG (16 mm ²)
Terminal-block torque	20 in-lb (2.26 Nm)

Terminal Block Connections

	L2	N	L1		L2	N	L1
Output				Input			

Installing the UPS

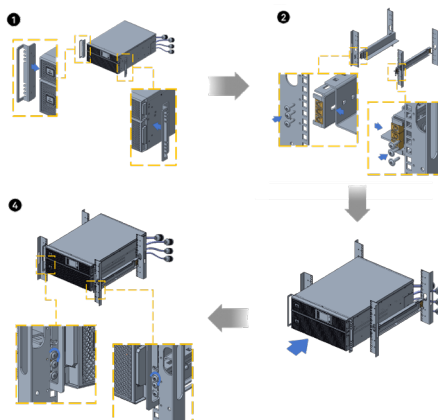

- Bundled with the EBC cable is a small autodetection cable with a 2 pin terminal block on either end. Connect the autodetect cable to the UPS terminal block 3 and the top terminal block on the EBC. Connect the top terminal block of each additional EBC to the right terminal block of the previous EBC.

5. Installing an Optional POD

To connect an optional POD:

1. On the rear of the unit, unscrew the two fixing screws from the POD-location cover and remove the cover.
2. Align the tabs on the bottom of the POD with the slots on the UPS, and press the POD onto the UPS.
3. Secure the POD to the UPS using two screws.

6. Connecting AC Input

Refer to the wiring table above for the recommended overcurrent protection.

- Remove the conduit-entry knockouts, and install input and output wiring in separate conduit.
- Refer to the figure above for the terminal-block connections.

Connect to an input-power supply that is properly protected by a circuit breaker in accordance with national and local electrical codes.

NOTE: Allow the batteries to charge at-least 8 hours before first start-up to ensure adequate back-up time. The batteries charge when the UPS is connected to AC input regardless of the off /on status of the UPS.

Powering the UPS

NOTE: Do not start the UPS until after the installation is finished, the system is commissioned by an authorized engineer, and the external input circuit breakers are closed.

1. Make sure the maintenance bypass switch is in the open “OFF” position and that the guard is secured in place.
2. Ensure that the REPO connector on the rear of the unit has a jumper between pins 1-2 or that it is properly wired to an Emergency Power- Off circuit (normally closed).
3. Make sure the breaker supplying power to the UPS is closed, and close the input breaker on the rear of the UPS.
4. If necessary, use the LCD display or a connected computer to make any required settings. (Refer to the User Guide for configuration set up).
5. Close all output breakers on the rear of the UPS (or in an external panel board, if used).
6. If external battery cabinets are included, close the breakers on the rear of each cabinet.
7. Power-on the UPS using the Operation and Display Panel (see the illustration to the right) by pressing and holding the power button until the confirmation dialog appears. Use the Up/Down arrows to select “YES”, then press Enter.



NOTE: During operation, the UPS may sound an alarm as the output receptacles are powered. You may press the Esc button for 2 seconds to silence the audible alarm.

Feature

Vertiv™ Power Assist is a free software available to Vertiv customers for monitoring your equipment protecting your data and stay up to date on device current state.

Please use the link below to download the software:

<https://www.vertiv.com/en-us/products-catalog/monitoring-control-and-management/software/vertiv-power-insight-application/>



To contact Vertiv Technical Support: visit www.Vertiv.com

© 2021 Vertiv Group Corp. All rights reserved. Vertiv™ and the Vertiv logo are trademarks or registered trademarks of Vertiv Group Corp. All other names and logos referred to are trade names, trademarks or registered trademarks of their respective owners. While every precaution has been taken to ensure accuracy and completeness here, Vertiv Group Corp. assumes no responsibility, and disclaims all liability, for damages resulting from use of this information or for any errors or omissions. Specifications, rebates and other promotional offers are subject to change at Vertiv's sole discretion upon notice.

