

Vertiv™ Rack RFID and Fingerprint Door Lock Handle



Quick Installation Guide

Vertiv™ Rack RFID and Fingerprint Door Lock Handle Part Number: VRA7002

Components

Figure 1 RFID and Fingerprint Door Lock Handle

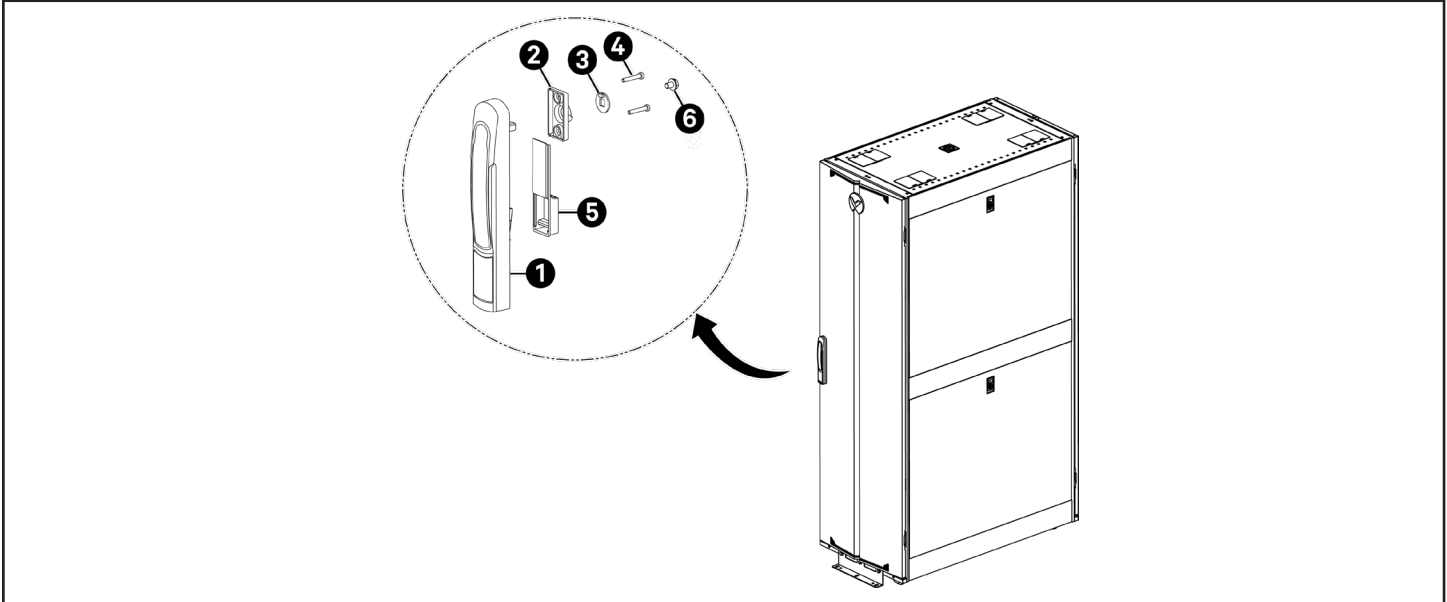

Item	Description	Quantity	Item	Description	Quantity
1	RFID and fingerprint door lock handle	1	4	Phillips screw (large and small)	2 for each
2	Sash housing	1	5	Cover cap (large and small)	1 for each
3	Cam	1	6	Hex head screw	1

RFID and Fingerprint Door Lock Handle Installation

To install on Vertiv single door:

1. Remove the existing door handle from the single door.

Unfasten the hex screw (3) and remove the locking latch (2). Save the locking latch for later use. Unfasten two pan head screws (5) and remove the holding bracket (4) and the door handle (1). See Figure 2.

Figure 2 Remove Door Handle

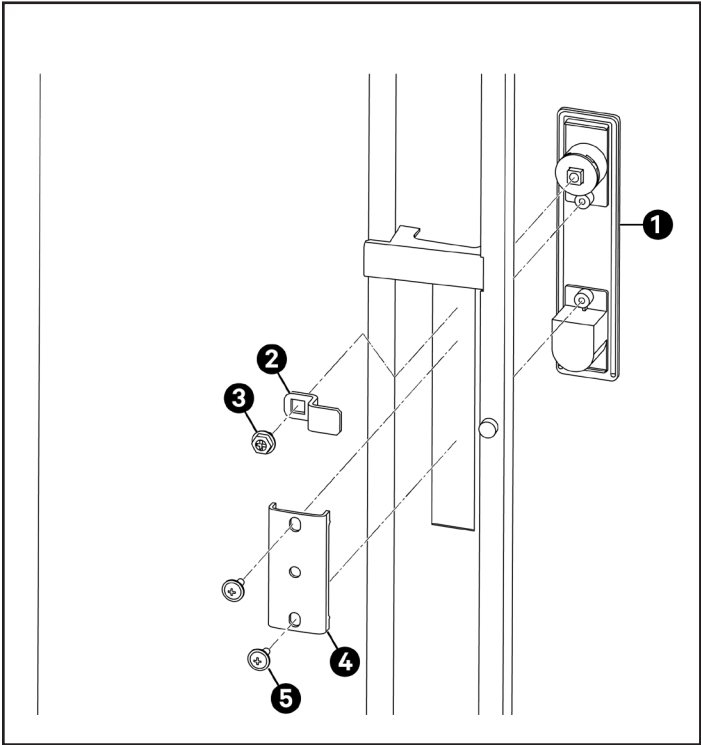

2. Install the RFID and fingerprint door lock handle on the single door.

- Slightly loosen the retaining plate (8) located under the Ethernet port, by loosening the screw on the plate. Hang the RFID and fingerprint door lock handle (1) into the cut out of the single door panel.
- Install the sash housing (2) on the mandrel of the lock with two Phillips screws (3).
- Place the cam (5) and the locking latch (6) removed from Step 1 onto the mandrel, and fix them with a hex head screw (7).
- Tighten the retaining plate (8).
- Hook the cover cap (4) at the top and click the cap at the bottom into the retaining plate (8). See Figure 3.

Figure 3 Install RFID and Fingerprint Door Lock Handle

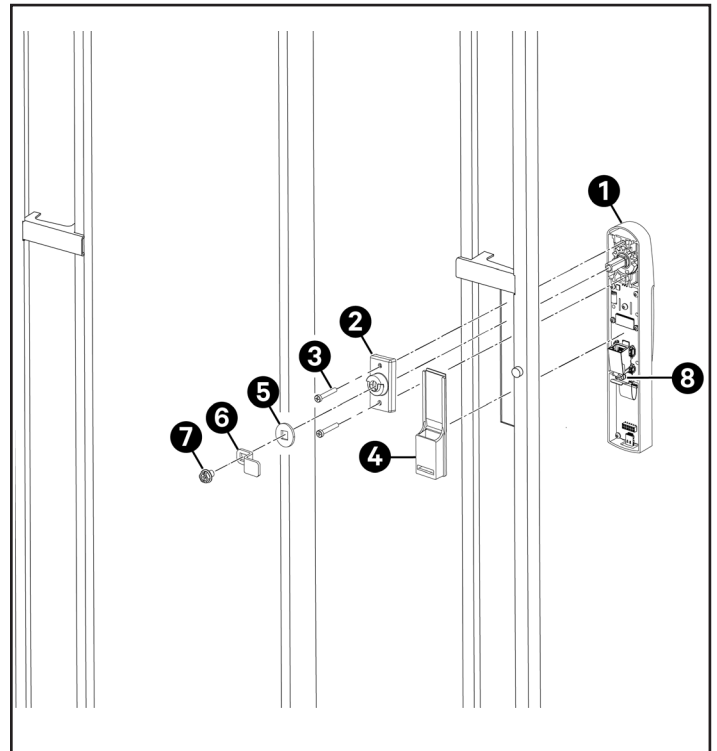

3. Connect power supply to the RFID and fingerprint door lock handle.

RFID and fingerprint door lock handle is powered by using a 48 V POE port. This can either be from a switch or a POE injector device. It can also be powered via the USB-C port if the POE source fails.

- The 48 V POE port (1) is at the back side of the handle.
- The USB-C port (2) is at the bottom of the handle. You need to unfasten the screws and remove the cover from the bottom. See Figure 4.

Figure 4 Connect Power Supply

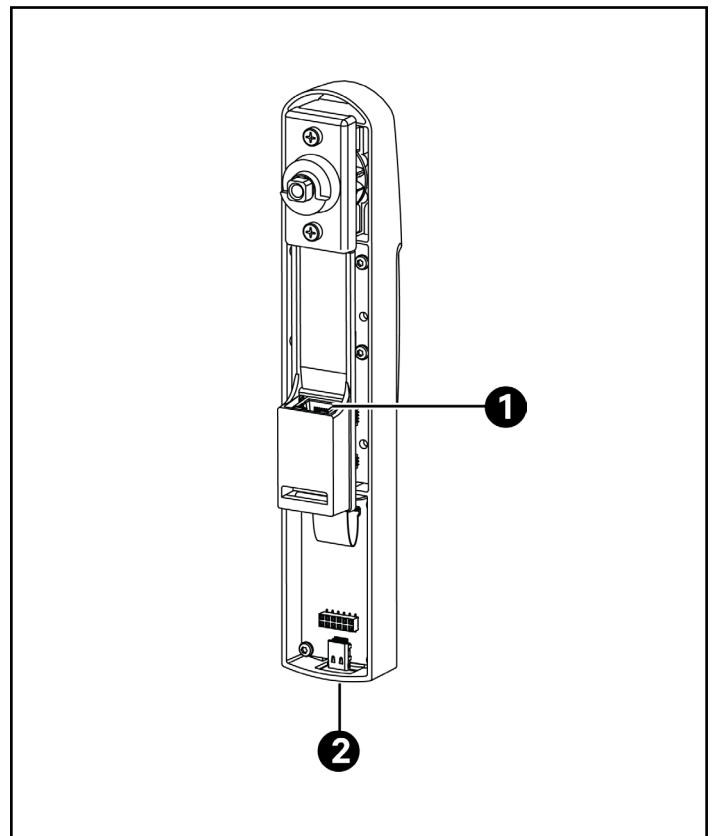

To install on Vertiv split doors:

1. Remove the existing door handle from the split doors.

Remove the hex screw (2) from the door handle (1). Unfasten two pan head screws (4) and remove the holding bracket (3). Remove the door handle (1). See Figure 5.

Figure 5 Remove Door Handle

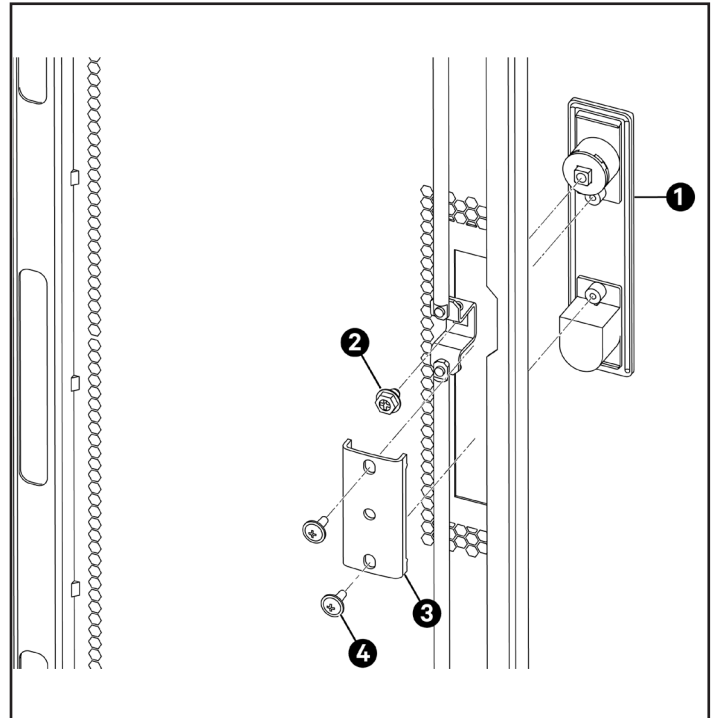

2. Install the RFID and fingerprint door lock handle on the split doors.

- Slightly loosen the retaining plate (7) located under the Ethernet port, by loosening the screw on the plate. Hang the RFID and fingerprint door lock handle (1) into the cut out of the door panel.
- Install the sash housing (2) on the mandrel of the lock with two Phillips screws (3).
- Place the cam (4) onto the mandrel, align the lever (8) with the cam, and fix them to the mandrel with a hex head screw (6).
- Tighten the retaining plate (7).
- Hook the cover cap (5) at the top and click the cap at the bottom into the retaining plate (7). See Figure 6.

Figure 6 Install RFID and Fingerprint Door Lock Handle

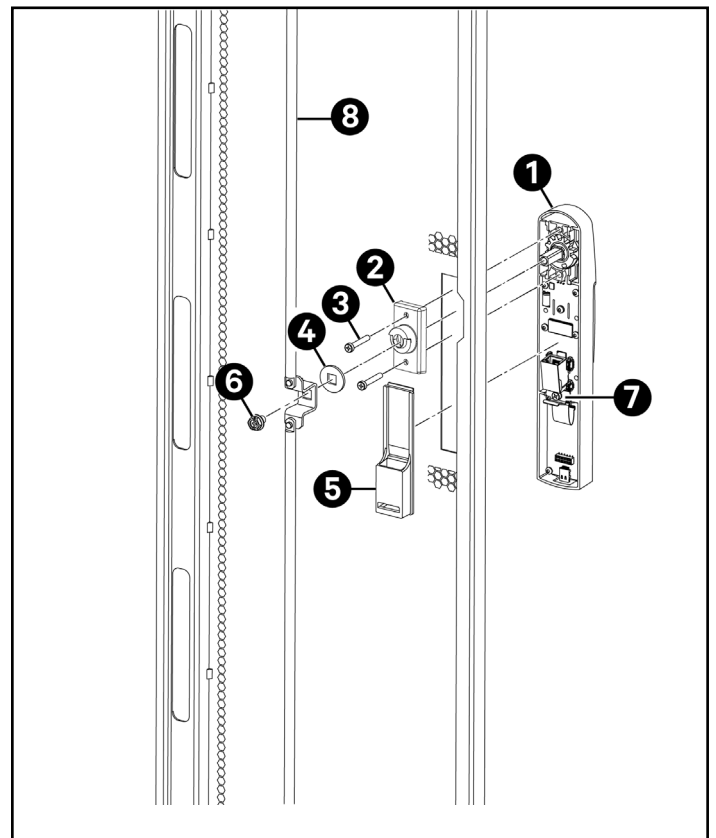

3. Connect power supply to the RFID and fingerprint door lock handle.

RFID and fingerprint door lock handle is powered by using a 48 V POE port. This can either be from a switch or a POE injector device. It can also be powered via the USB-C port if the POE source fails.

- The 48 V POE port (1) is at the back side of the handle.
- The USB-C port (2) is at the bottom of the handle. You need to unfasten the screws and remove the cover from the bottom. See Figure 7.

Figure 7 Connect Power Supply

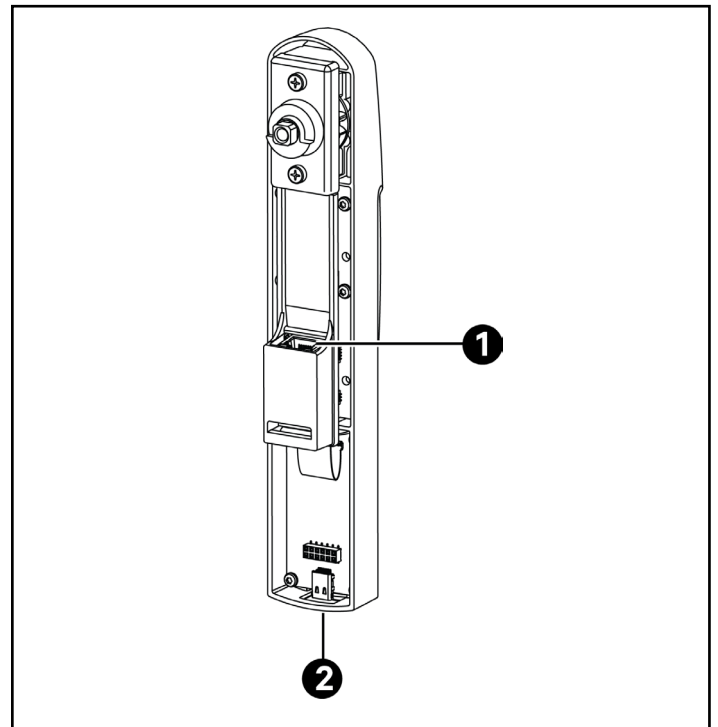

How to Guides



<http://tanlocks.info/vertiv/HowTos/>

NOTE: Please scan this code to access our “How to Guides” and discover more product functionality.

To contact Vertiv Technical Support: visit www.Vertiv.com

© 2025 Vertiv Group Corp. All rights reserved. Vertiv™ and the Vertiv logo are trademarks or registered trademarks of Vertiv Group Corp. All other names and logos referred to are trade names, trademarks or registered trademarks of their respective owners. While every precaution has been taken to ensure accuracy and completeness here, Vertiv Group Corp. assumes no responsibility, and disclaims all liability, for damages resulting from use of this information or for any errors or omissions.

