

Vertiv™ CoolPhase Ceiling Condensate Pump Kit



Quick Installation Guide

Purpose: This Instruction gives detailed information on installing the Vertiv™ CoolPhase Ceiling Condensate Pump Kit, part number - CEILPMPKIT-L and CEILPMPKIT-H.

Warning: Risk of arc flash and electric shock. Can cause serious injury or death. Open all local and remote unit electric power supply disconnect switches, verify with a voltmeter that power is off and wear OSHA approved personal protection equipment per NFPA 70E before working within the unit electric control enclosure or making any electrical connections/disconnections. This kit must be installed only by qualified HVAC service personnel.

Caution: Risk of improper auxiliary float switch wiring. Can cause failure of high water alarm activation and unit shutoff resulting in catastrophic building and equipment damage from water overflowing the condensate pump.

General: The 1 through 8 ton Vertiv™ CoolPhase Ceiling Condensate Pump Kit is to be attached to the unit per instructions below.

Condensate Pump Components:

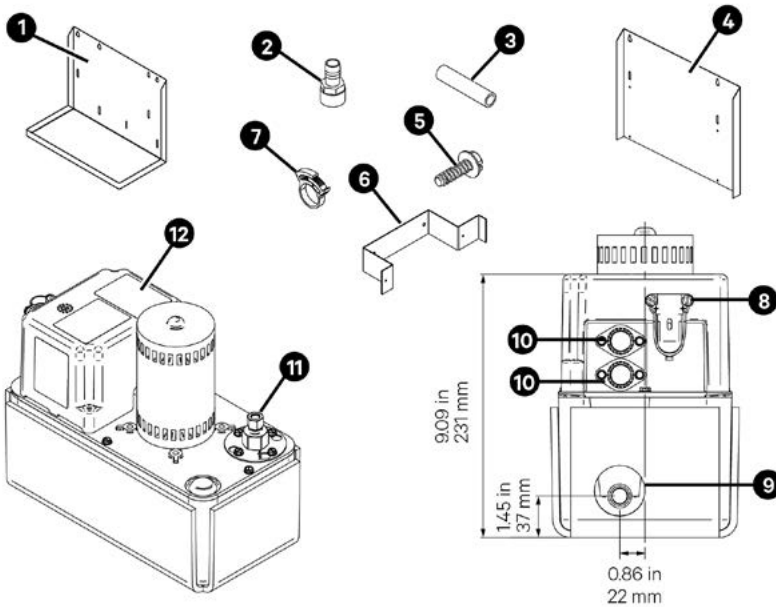

Item	Description	Quantity
1	Bracket galvanized steel	1
2	3/4 Barb to 3/4 FNPT, Nylon	1
3	Hose 3/4, high temperature	2
4	Extension bracket	1
5	Screw PHPNHD type AB	6
6	Gusset galvanized steel	2
7	Clamp, snap-grip 61/64	2
8	Flex electrical connection	2
9	Hose barb-inlet	1
10	Fuse holder	2
11	Outlet	1
12	Condensate pump	1

Installation Instructions

1. Disconnect all power to unit.
2. Remove the service access panels (1), see figure on the right.

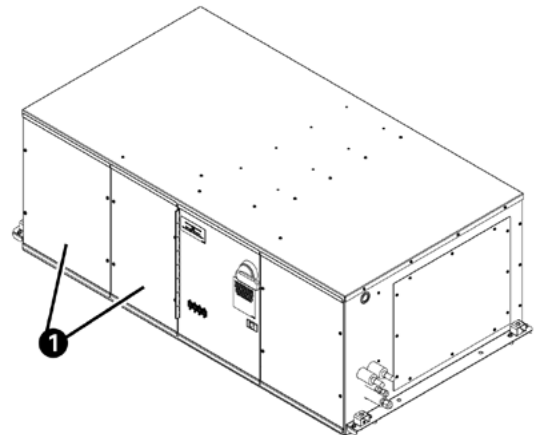

3. Connect flexible assembly tubing (supplied with ceiling condensate pump kit) to the hose barb (1) on pump tank with supplied hose clamp. Flexible rubber tubing assembly must be installed on the condensate pump end of the rigid piping, see below figure.

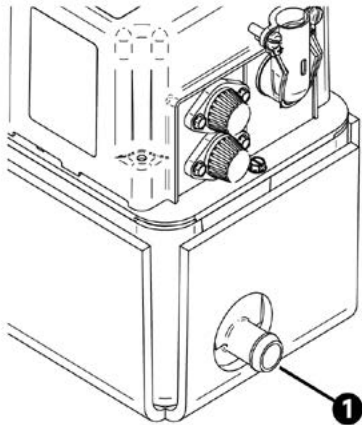

4. The drain connection at the cooling unit and the pump is 3/4 inch NPT female. Do not trap between the unit and pump.
5. The pump must be mounted so that the drain line is pitched downward a minimum of 1/2 inch from the unit drain outlet to the pump inlet. To accomplish this, the bottom of the pump mounting bracket must be no higher than 3/4 inch from the bottom of the unit. The pump must be level within 1/16 inch to assure proper operation and achieve published capacity.
6. Remove access panels.
7. Run pump power wiring from the condensate pump cutting through the grommet and guiding the wire all the way to the electrical box.
 - a. Connect L1, L2 to the high voltage terminal block.
 - b. Connect the ground lead to the grounding lug located near the terminal block.
 - c. Fuses are located internal to the pump.
 - d. The installer to supply flexible conduit between the unit and pump per local code.
8. In all units locate distribution block for condensate pump power supply on the EP box for 1-PH unit DTB L1 & DTB L2 for 3-PH unit DTB L1 & DTB L3. For AUX CP float switch all units locate wires splicer. Refer to the unit electrical schematics to see the connections.
9. The conduit must run from the condensate pump to the electric box on the Vertiv™ CoolPhase Ceiling unit so as to not block filter access.

Mounting Options Compatible with 1, 2, and 3 ton (MMI12, MMI24, and MMI36).

Mounting Option 1

- The condensate pump is to be mounted to the back of the unit, or on the air inlet end using the condensate pump support bracket supplied.

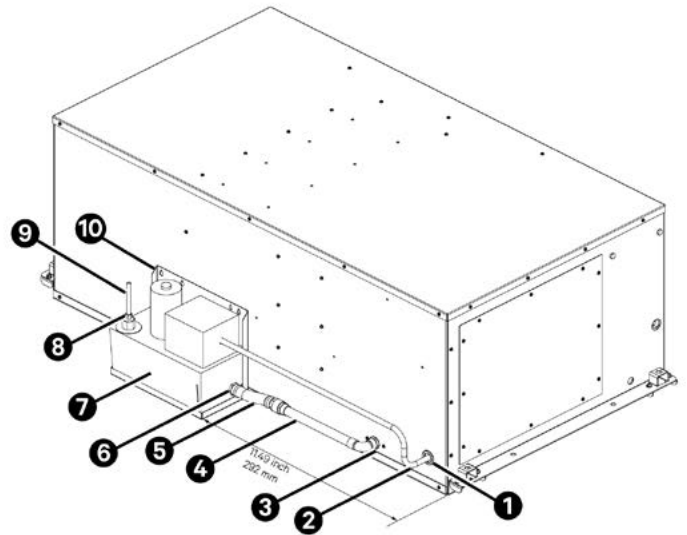

Item	Description
1	Electrical entrance for condensate pump connection
2	Power supply from electrical panel box in unit
3	NPT female condensate drain connection
4	Field supplied rigid tubing (support as required)
5	Flexible rubber tubing
6	FPT customer connection
7	Condensate pump
8	Compression fitting drain connection
9	Drain line (field supplied)
10	Condensate pump support bracket

Recommended Torque Value for 3/8 inch Check Valve (Hartell P/N 670042):

- Min torque: 12 ft. lbs
- Max torque: 15 ft. lbs

Mounting Option 2

Note: Compatible with 1, 2, and 3 ton (MMI12, MMI24, and MMI36).

- If the unit air is to be ducted, the condensate pump should be mounted to the air duct using the condensate pump support bracket provided.
 - To install the support bracket onto duct, drill four 5/32 inch (4 mm) x 1/8 inch (3.2 mm) deep holes in duct as shown, do not drill through insulation and attach bracket with 5/32 inch (4 mm) x 1/2 inch (13 mm) sheet metal screws supplied in kit.

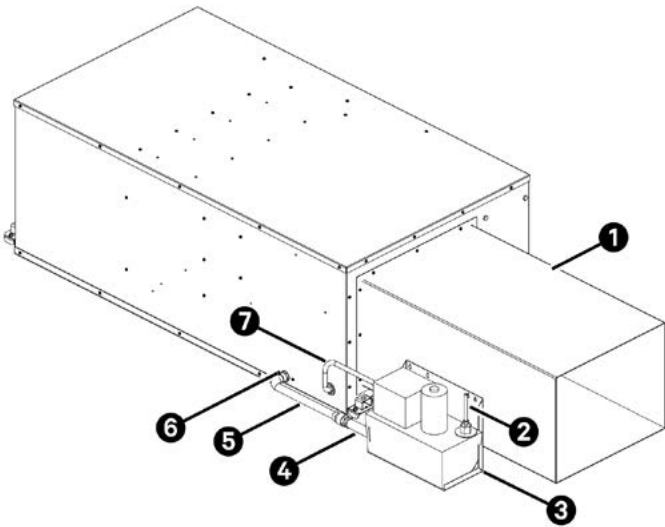

Item	Description
1	Air duct
2	Field supplied drain line
3	Condensate pump support bracket
4	Flexing tubing
5	Field supplied rigid piping between unit and pump. 3/4 inch (19 mm) minimum, support piping as required do not trap.
6	Drain connection 3/4 inch (19 mm) NPTF recessed
7	Field supplied flexible conduit for condensate pump wiring

Mounting Option 3

Note: Compatible with 1, 2, and 3 ton (MMI12, MMI24, and MMI36).

- If the unit air is not ducted, mount the condensate pump to the discharge end of the cooling unit using two standoff brackets and condensate pump support bracket, all brackets provided in kit.
 - To install the support bracket onto duct, drill four 5/32 inch (4 mm) x 1/8 inch (3.2 mm) deep holes in duct as shown, do not drill through insulation and attach bracket with 5/32 inch (4 mm) x 1/2 inch (13 mm) sheet metal screws supplied in kit.

Notes:

- Use the wire harness supplied with the pump. install the wiring as per National Electric Code and all local codes.
- Refer to unit electrical schematic.
- Connect and run the drain line from the pump to a suitable drain per local codes.
- Reinstall access panel.
- Reapply power to unit.
- Run unit to verify all pumps are running properly.

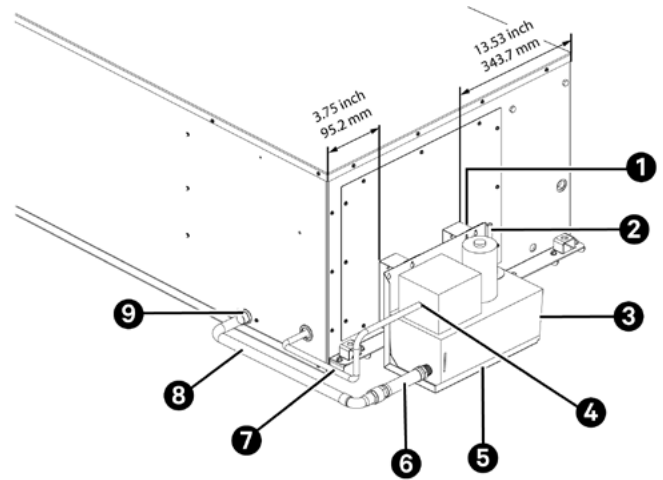

Item	Description
1	Standoff Bracket
2	Field supplied drain line
3	Condensate pump
4	Condensate pump wiring entrance
5	Condensate pump support bracket
6	Flexible tubing assembly
7	Field supplied flexible conduit for condensate pump wiring
8	Field supplied rigid piping between unit and pump 3/4 inch (19 mm) ID minimum Support as required, do not trap.
9	Drain connection 3/4 inch (19 mm) NPTF

Vertiv™ CoolPhase Wall Condensate Pump Kit

Quick Installation Guide



Mounting Options Compatible with 4, 5, and 8 ton (MMI48/60, MMI96).

Mounting Option 1

- If the return air is to be ducted, a mounting kit (part number 10175393G1), hardware and two mounting bracket must be ordered from Vertiv™. Mount the condensate pump support bracket on the unit directly to the panel using four screws, four lock washers, and four flat washers from kit.

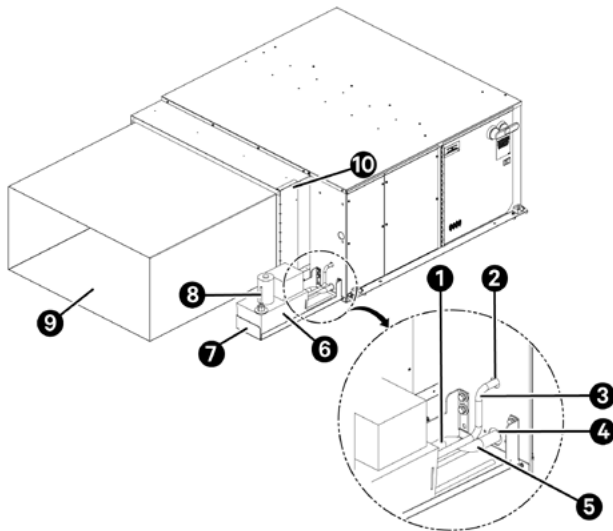

Item	Description
1	Flexing tubing
2	Condensate pump electrical connection
3	Field supplied flexible electrical conduit (Do not block filter access)
4	Drain connection 3/4 inch (19 mm) NPTF
5	Field supplied rigid drain piping between condensate pump and unit. Diameter is 3/4 inch (19 mm) minimum, support as required Do not trap.
6	Condensate pump
7	Condensate pump support bracket (mount flush with bottom of unit)
8	Field supplied drain line
9	Duct
10	Filter access door.

Optional wiring of float switch to unit shutdown terminals

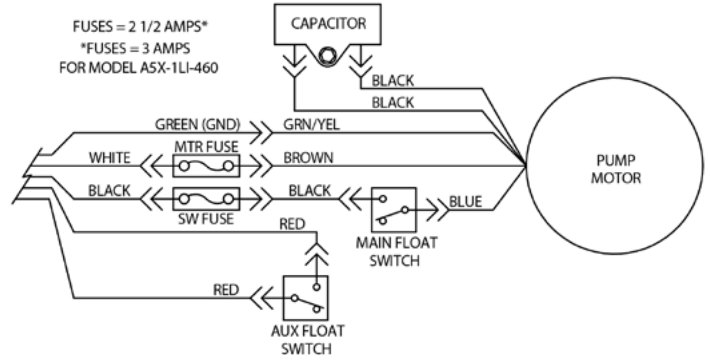

Installation Notes

- Use Seamless Copper tubing only, annealed or hard. For Annealed tubing use lower range of the recommended torque values.
- The torque values can vary considerably depending on thread condition, adequate sealing can occur at values much lower than recommended.
- If thread sealant or lubricant is used, maximum torque values should be decreased by 25%.
- Tubing to be free of wrinkles, flats and humps.
- Tubing shall be cut using tools specifically designed and maintained with a sharp cutting surface for this purpose.
- Ensure tubing is clean and deburred after cuts, remove all filings, chips and grit before attachment of fittings.
- Do not use teflon tape on tube end of fitting body threads.
- Insert tubing end until it bottoms against shoulder in fitting body.
- Tighten nut finger tight while holding tube end against shoulder in fitting body.
- If unexpected resistance is felt when threading nut to finger tight, then fitting should be cleaned or replaced.
- Do not force an improperly fitted tube line into the fittings.
- Never permit the fitting body to rotate during tube end make-up. two wrenches must be used.
- If fitting leaks, tighten fitting in increments of 1/4 hex flat until leak stops.
- If fitting still leaks, take fitting apart and examine for scratches, damaged threads or improper tubing alignment.
- Determine if fitting should be replaced.

To contact Vertiv Technical Support: visit www.Vertiv.com

© 2026 Vertiv Group Corp. All rights reserved. Vertiv™ and the Vertiv logo are trademarks or registered trademarks of Vertiv Group Corp. All other names and logos referred to are trade names, trademarks or registered trademarks of their respective owners. While every precaution has been taken to ensure accuracy and completeness here, Vertiv Group Corp. assumes no responsibility, and disclaims all liability, for damages resulting from use of this information or for any errors or omissions.

