

## Handling the Unit While Packaged

Transport packaged unit using a fork lift or pallet jack.

- When using a fork lift or pallet jack, make sure forks (if adjustable) are spread to widest allowable distance to still fit under pallet. Make sure fork length is suitable for pallet length. Pallet length is 60" (1524mm). When a forklift is used, insert the tines of the forklift in the direction as shown in the figure below.
- Packaged unit shall not be lifted any higher than 2"- 4" (51-102mm) off ground when handled. All by-standing personnel shall be no closer than 12' (3.7m) to handled packaged unit.
- If circumstances require unit to be lifted higher than 4" (102mm) great care shall be exercised and all by-standing personnel are to be no closer than 20' (5m) to lift point of unit.

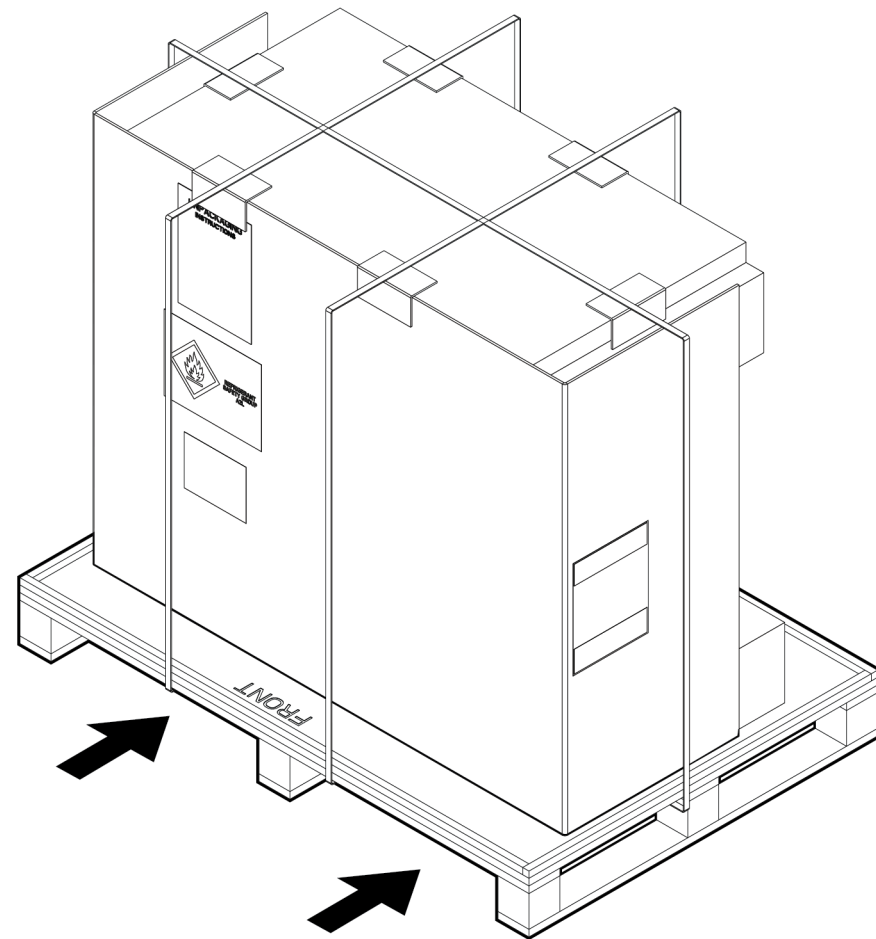

## Safety Information



### WARNING

Risk of improper handling and contact with sharp edges, splinters and exposed fasteners. Can cause equipment damage, injury, or death. Use only trained and fully qualified technicians wearing appropriate OSHA approved personal protection equipment (PPE) who have read all of the following instructions to move, lift, remove packaging from, or prepare the unit for installation.



### CAUTION

Risk of contact with sharp edges, splinters, and exposed fasteners. Can cause injury! Wear appropriate OSHA approved personal protective equipment (PPE) when attempting to move, lift, remove packaging from, or prepare unit for installation.

### NOTICE

Risk of passageway interference. Can cause unit and/or structure damage. Refer to the installation plans and measure the unit and all passageway dimensions prior to moving the unit to verify clearances.

### NOTICE

Risk of improper forklift operation. Can cause unit damage. Keep tines of the forklift level and at a height suitable to fit under the pallet.

## Equipment Inspection

Upon arrival of the unit, and before unpacking, verify that labeled equipment matches Bill of Lading. Carefully inspect all items for either visible or concealed damage. Damage should be immediately reported to carrier and a damage claim filed with a copy sent to Vertiv or to your sales representative.

## Packing Material

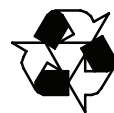

All material used to package this unit is recyclable. Please save for future use, or appropriately dispose of material.

## Recommended Unit Handling Equipment

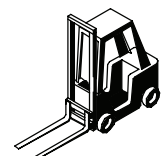

Fork Lift

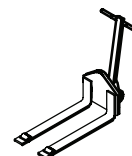

Pallet Jack

## Handling Instructions for Vertiv™ CoolPhase Condensing Unit 15 kW Models

Reference guide for receiving,  
unpacking and preparing for  
installation.  
**DO NOT THROW AWAY!**

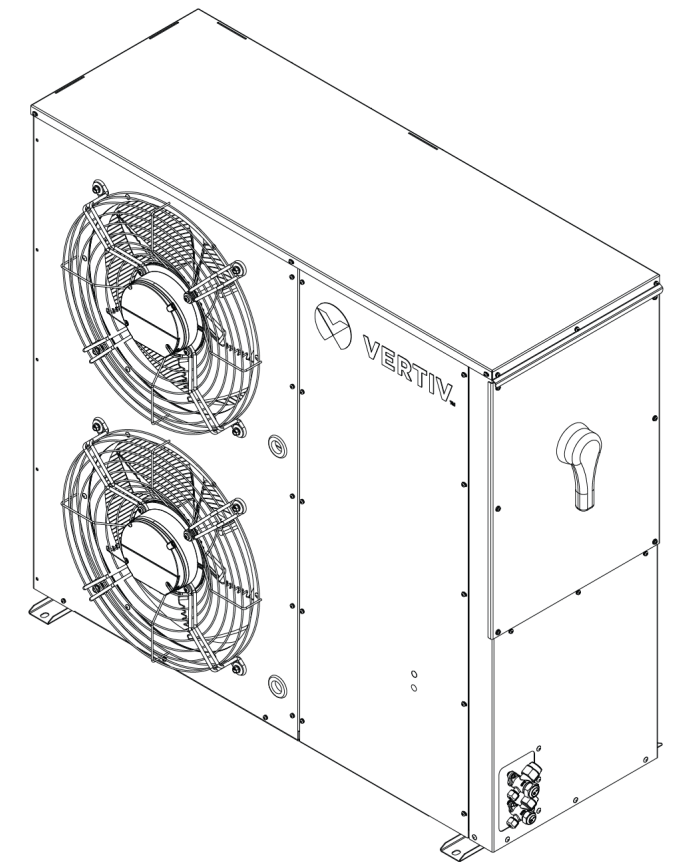

## Unpacking Unit

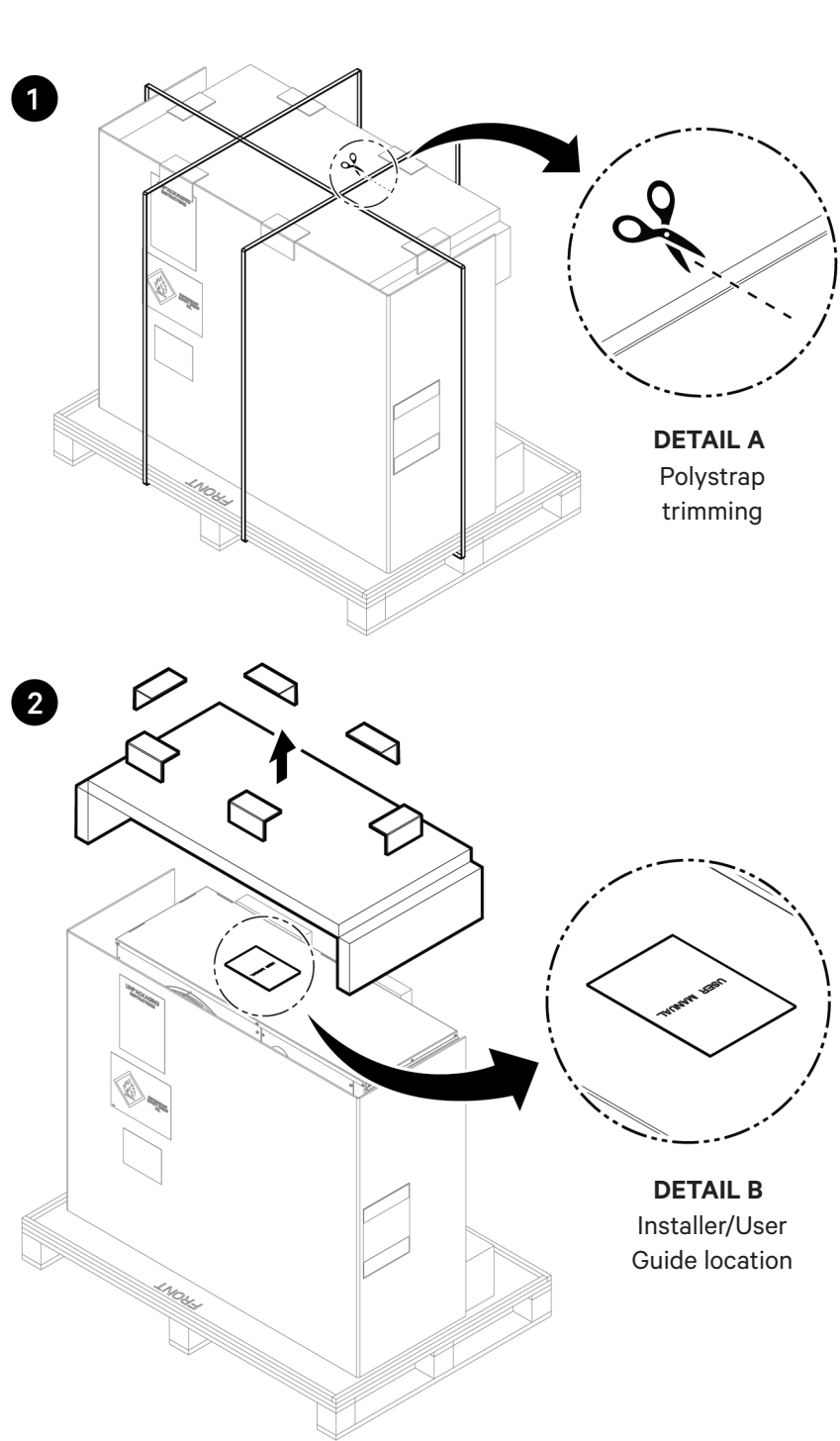

### Step 1:

- Place the package on a flat surface, then trim the polystraps to release the unit.

### Step 2:

- Remove the protector corners and the honeycomb, then take off the user manual from the top.

### Step 3:

- Step aside the cardboard and the corrugated packaging material that protects the unit on the front of the package.

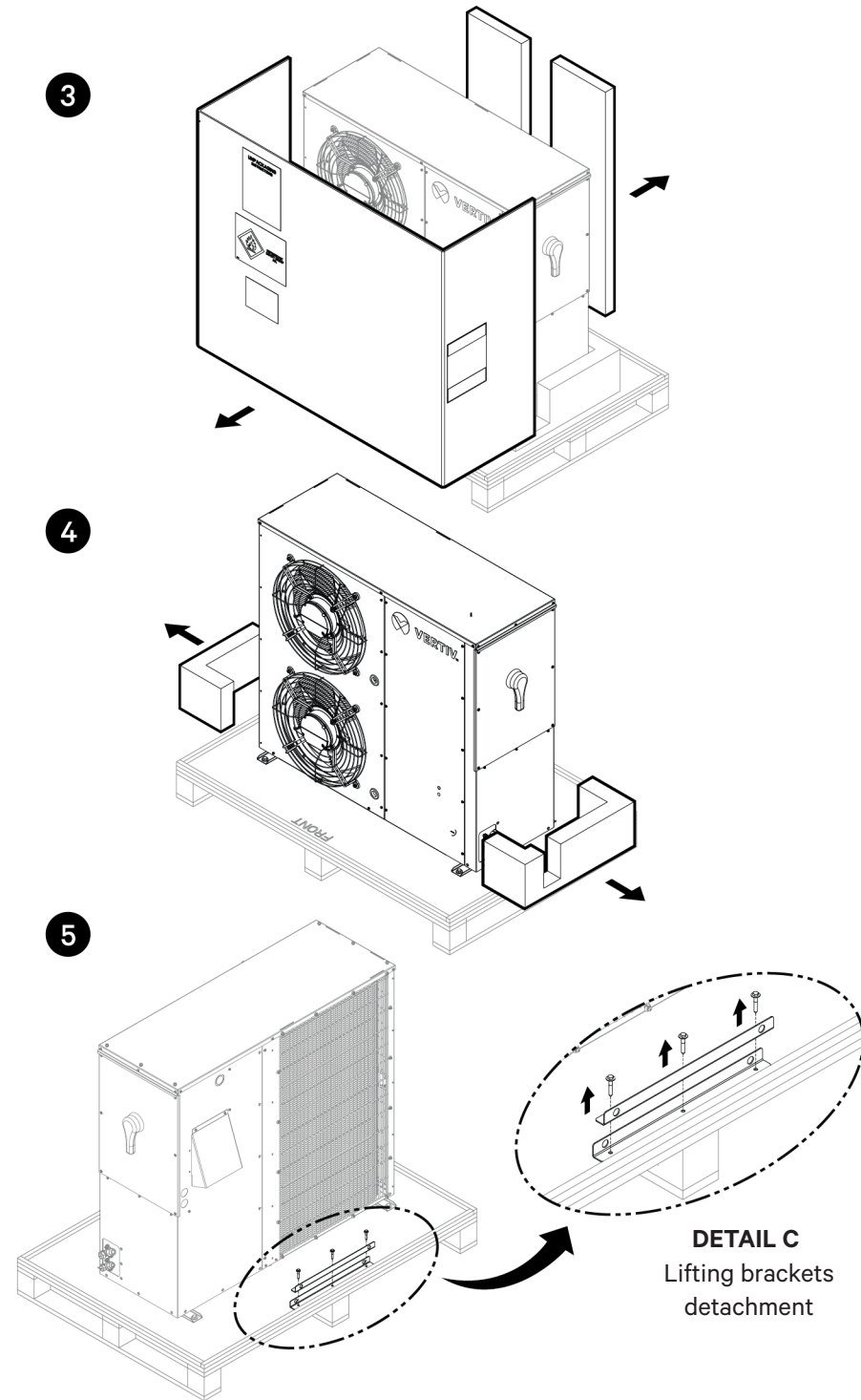

### Step 4:

- Remove the foam pads on the base of the unit to access the anchoring base brackets.

### Step 5:

- Lastly, detach the lifting brackets from the pallet by removing the 3 screws attached to them, then proceed to detach the condenser from the pallet as established in the following section.

## Removing Unit from Pallet

To remove the unit from the pallet follow the indications bellow:

### Step 1:

- Remove the shipping brackets from the pallet by removing four 3/8" hex screws and washers for each bracket.

### Step 2:

- Lift the unit with the help of a crane.

### Step 3:

- Hoist the Unit to its designated installation location with the help of a crane, anchoring the slings to the lifting brackets.

**NOTE: A minimum height span of 50 cm (19.68 in) is required to lift the unit off the shipping pallet safely.**

